

pūrleveTM

hygienic door handle

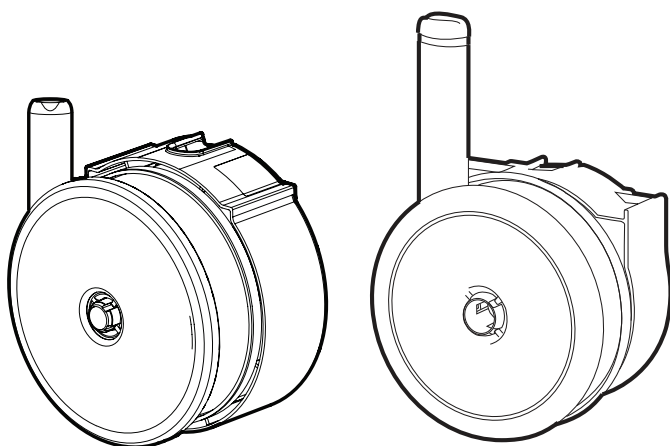

PŪRLEVE HYGIENIC REFILL SLEEVE REPAIR

Use with Refill - #1004 and #1005



A cleaner world is within reach.

111 W. Olive Street, Glendale, WI 53212
1.877.PURLEVE | www.purleve.com

Pūrleve Hygienic Refill Sleeve Repair

Note 1: Installation video located at - www.purleve.com/installation-videos

Note 2: Instructions used for both #1004 and #1005 refill.

Note 3: If sleeve is not split but broken and not covering the handle, please cut the sleeve. Then go to Step #8 for repair process.

Note 4: The counting function for low refill only functions when a new and full refill is placed. The counting feature will not work if a less than full refill is used.

REPAIR REFILL INSIDE OF PŪRLEVE HANDLE

- ① Insert the Pūrleve key into cover lock, turn either direction and open cover (Figure 1).

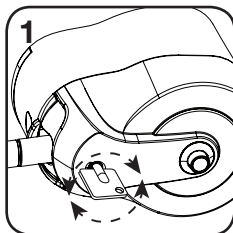

- ② Place the switch to the 'OFF' position (Figure 2).

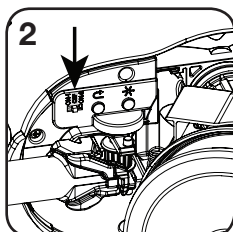

- ③ Remove Plastic Handle.

- ④ Pull sleeve approximately 5" to 7" (13-18 cm) past the metal handle (Figure 3).

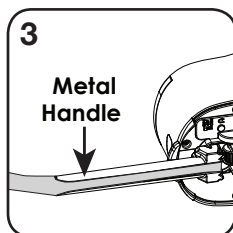

- ⑤ Insert sleeve into Plastic Handle and push through (Figure 4). Ensure sleeve is not twisted.

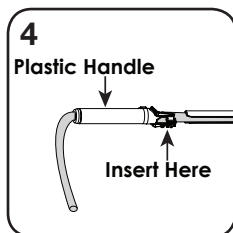

- ⑥ Hold end of sleeve stationary and slide Plastic Handle over the Metal Handle until it stops. Ensure the sleeve remains in Metal Handle slot (Figure 5).

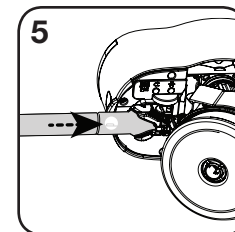

- ⑦ Cut sleeve end at approximately a 45° angle. Cut the damaged part of the sleeve away and recycle. Tear sleeve along perforation to top of Plastic Handle (Figure 6).

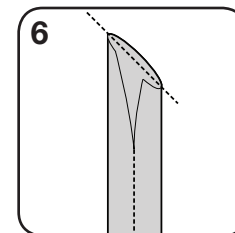

- ⑧ Grab ends of torn sleeve and pull sleeve back over (invert the sleeve) the handle cover about 6" (16 cm) past the end of the Plastic Handle (Figure 7). The perforation should be located on the back side of Plastic Handle.

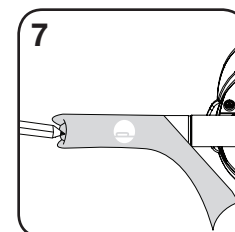

- ⑨ Loop sleeve through hook feature in Plastic Handle (Figure 8).

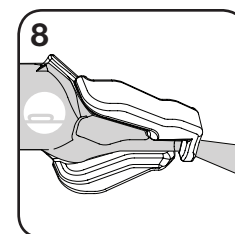

- ⑩ Pull about 6" (15.5 cm) of excess sleeve through Plastic Handle (Figure 9).

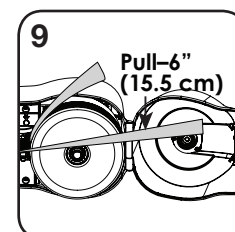

- ⑪ Locate the sleeve end from the used side of the refill and sleeve end from the new side of the refill. Tightly tie ends together (Figure 10).

Note 5: If slack is needed, unwrap sleeve from the used side of the refill.

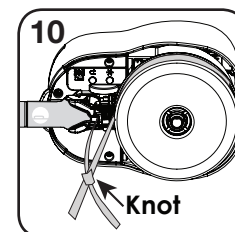

- ⑫ Cut excess sleeve from both ends of the knot so that the ends of the sleeves do not extend out side of the refill cover. This will avoid sleeve from jamming the system (Figure 11).

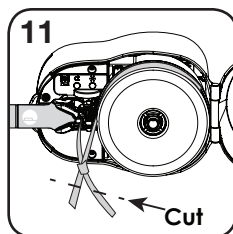

- ⑬ Turn the refill slowly by hand clockwise to ensure there is no binding of the sleeve (Figure 12).

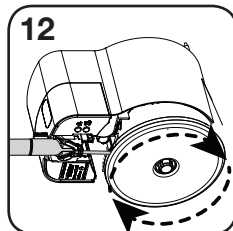

- ⑭ Turn 'On' the dispenser by placing the switch to 'On-1' OR 'On-2' (Figure 13). Do Not restart Count feature. This function only works when a new and full refill is placed.

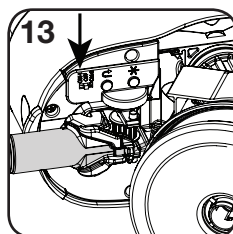

- ⑮ Close the cover. Ensure you feel a positive 'close' and hear a snap. Check for any gaps around the cover and dispenser. Use the Pürleve Key to ensure the lock is fully activated and gap removed.

- ⑯ Pull or Push Down the Handle and Release. This will 'test' to ensure the sleeve advancement is functioning successfully.

REPAIR REFILL OUTSIDE OF PÜRLEVE HANDLE

- ① Insert the Pürleve key into cover lock, turn either direction and open cover (Figure 1).

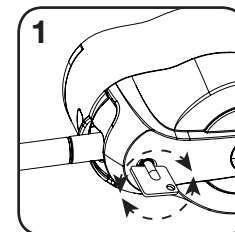

- ② Place the switch to the 'OFF' position (Figure 2).

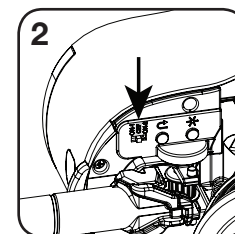

- ③ Remove Refill and Plastic Handle.

- ④ Grab damaged sleeve and pull approximately 16" (41 cm) from the Refill (Figure 3)

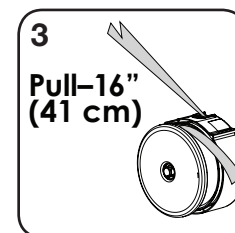

- ⑤ Insert sleeve through bottom of Plastic Handle and push through so that at least 12" (31 cm) of sleeve is sticking through the Plastic Handle. Ensure the sleeve is not twisted (Figure 4)

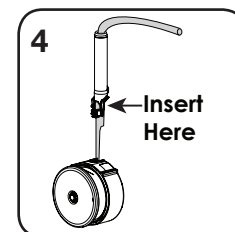

- ⑥ Cut sleeve end at approximately a 45° angle. Cut the damaged part of the sleeve away and recycle. Tear sleeve along perforation to top of Plastic Handle (Figure 5).

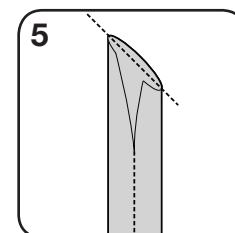

- ⑦ Grab ends of torn sleeve and pull sleeve back over (invert the sleeve) the handle cover about 6" (16 cm) past the end of the Plastic Handle (Figure 6). The perforation should be located on the back side of Plastic Handle.

- ⑧ Loop sleeve through hook feature in Plastic Handle (Figure 7).

- ⑨ Pull about 6" (15.5 cm) of excess sleeve through Plastic Handle (Figure 8).

- ⑩ Locate the sleeve end from the used side of the refill and sleeve end from the new side of the refill. Tightly tie ends together (Figure 9).

Note 6: If slack is needed, unwrap sleeve from the used side of the refill.

- ⑪ Cut excess sleeve from both ends of the knot so that the ends of the sleeves do not extend out side of the refill cover. This will avoid sleeve from jamming the system (Figure 10).

- ⑫ Slide plastic handle with sleeve onto metal handle. Ensure printed side of sleeve faces user. Ensure sleeve that is between the refill and the plastic handle is in the metal handle channel (Figure 11).

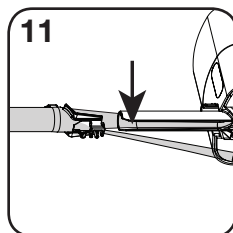
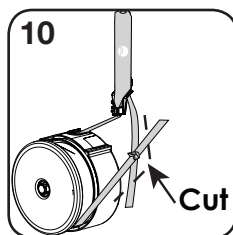
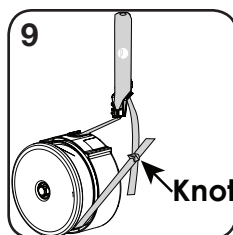
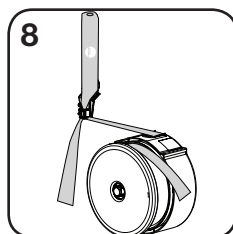
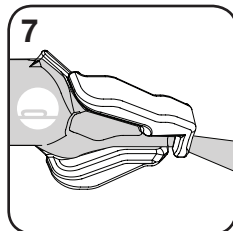
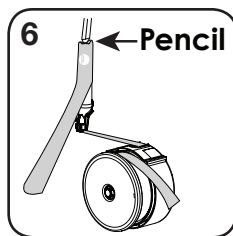

- ⑬ Slide plastic handle over the metal handle until it stops (Figure 12). Ensure sleeve between plastic handle and cartridge remains taught.

- ⑭ Insert refill into dispenser. Refill fits dispenser in only one position. Line up plastic ribs of refill with dispenser (Figure 13).

- ⑮ Turn the refill slowly by hand clockwise to ensure there is no binding of the sleeve (Figure 14).

- ⑯ Turn 'On' the dispenser by simply placing the switch to 'On-1' OR 'On-2' (Figure 15). Do Not restart Count feature. This function only works when a new and full refill is placed.

- ⑰ Close the cover. Ensure you feel a positive 'close' and hear a snap. Check for any gaps around the cover and dispenser. Use the Pürleve Key to ensure the lock is fully activated and gap removed.

- ⑱ Pull or Push Down the Handle and Release. This will 'test' to ensure the sleeve advancement is functioning successfully.

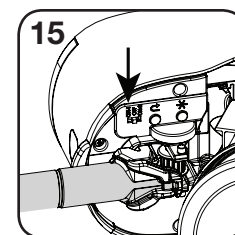
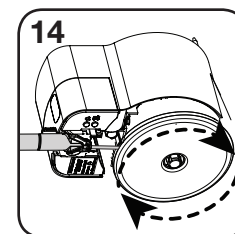
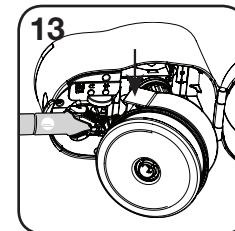
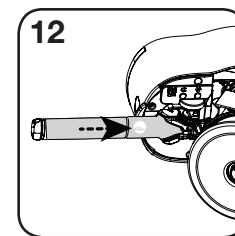



A cleaner world is within reach.

111 W. Olive Street, Glendale, WI 53212
1.877.PURLEVE | www.purleve.com