

# pūrleve™

hygienic door handle

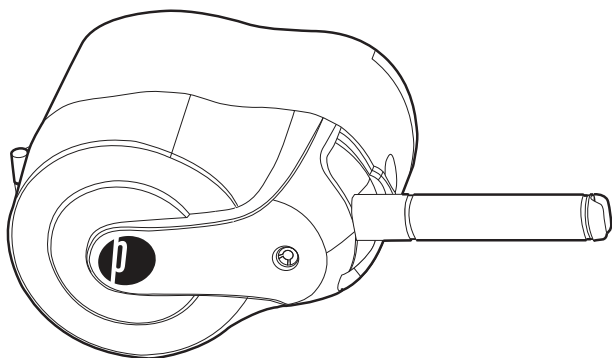

## #1002 PŪRLEVE HANDLE INSTALLATION

Bored Cylindrical Hardware

---

Hygienic Lock or Latch Door Handle System



A cleaner world is within reach.

111 W. Olive Street, Glendale, WI 53212  
1.877.PURLEVE | [www.purleve.com](http://www.purleve.com)

# Part List

## Tools Required

- Cross Tip Screw Driver (Phillips')
- Tape Measure
- Power Drill
- #2 Cross Tip Power Bit (minimum 3 1/2" (88.9 mm))
- 7/64" Drill bit (2.78 mm)
- Level

## Tools Recommended

- Center Punch
- Pencil
- Tape

## Included Parts

**Note 1:** See back page for other items required sold separately.

- Pūrleve #1002 Handle
- Pūrleve proprietary key
- C-cell Alkaline Batteries (Qty. 4)
- Pūrleve Informational Placard (Qty.2)
- Pūrleve Lock Button or Latch Accessories
  - a. Lock Cover
  - b. Push Button Ring
  - c. Push Button
  - d. Push Button Connector - (included with #1003 or #1014)
  - e. Stop Screw - not used

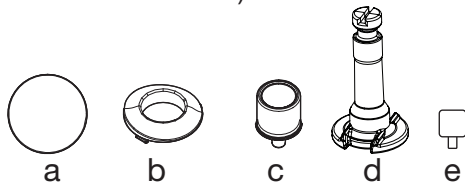

## Included Hardware

**Note 3:** Use the 'scaled' images as references during installation.

#8-32 x 5/8" (16 mm) Pan Head Machine Screw (Qty. 4)



# Pūrleve Handle #1002 Installation Instructions

**Note 2:** Installation video located at -

[www.purleve.com/installation-videos](http://www.purleve.com/installation-videos)

**Note 3:** Use accessory kit #1003 coin turn or #1014 keyed lever.

## Door Preparation and Trouble Shooting Guide

- Standard Door Thickness is 1 - 3/8" (35 mm) thick. If the door is LESS than 1.375" (35 mm) or GREATER than 1.75" (44.5 mm) the system will not function properly. Call Pūrleve for support.
- The following instructions cover standard Solid Wood Doors.
- For Fiberglass or Hollow Core Wood Doors, please see alternative directions or call Pūrleve.
- Metal Door installation is similar to these instructions. Call Pūrleve with any questions.
- If no installed door return mechanism on door, please call Pūrleve to purchase an Industrial Door Closure Product #1012.
- For new door with no hardware holes, go to the separate instructions included; labeled Bored Cylindrical Hardware Door Preparation.
- If hardware currently in door, please remove entire set.
- The standard "Backset" of the included latch is 2 - 3/4" (70 mm). That is, the distance from the edge of the door to the center of the hole in the door is 2 - 3/4" (70 mm). If the distance is 2-3/8" (60 mm), please call Pūrleve to order accessory #1016 (Coin Turn Lever Hardware) or #1017 (Keyed Lever Hardware).

## 1 INSTALL DOOR HANDLE HARDWARE

**Note 4:** Ensure the Pürleve LOCK HOUSING does not extend outside the hole in the door. If it protrudes, the handle will not function properly. DO NOT tighten outside handle rose until Pürleve mounting plate has been fastened to Pürleve LOCK HOUSING.

**Note 5:** 1" (25 mm) long Pan Head Wood Screws (Qty. 4) are NOT required for test trials. This will avoid any holes being made in door.

- a Install latch with included 3/4" (19 mm) Flat Head Screws (Qty. 2). The flat edge of the latch should face the direction the door opens (Figure 1).

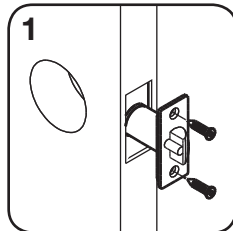

- b See Note 4. Install lever and lock housing into door hole. Ensure the lock housing engages with the latch prongs and retractor interlocks with the latch tail (Figure 2).

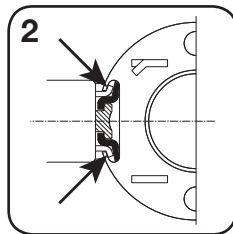

- c Install the Pürleve mounting plate on to the door hardware with 5/8" (15 mm) flat head wood screws (Qty. 2). To avoid stripping the screws, do NOT overtighten. The flat edge of the mounting plate should face away from the edge of the door and remain vertical. The flat side of the mounting plate should face the door and the bosses of mounting plate should face away from door (Figure 3).

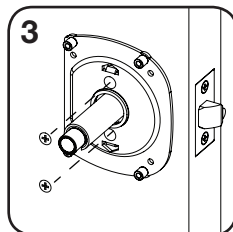

- d See Note 5. Install and tighten 1" (25 mm) Pan Head Wood Screws through mounting plate into the door (Qty. 4). If you require a pilot hole for these screws, make a 7/64" (2.78 mm) hole. (Figure 4).

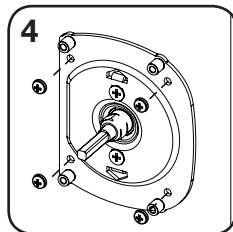

## 2 PREPARE PÜRLEVE HYGIENIC DOOR HANDLE

### OPTION - Handle Latch Only (no push button lock)

- a Snap included lock cover (a) from accessories on the Pürleve Handle cover (Figure 5). Ensure the larger of the three snaps matches the largest of the three holes on handle cover.

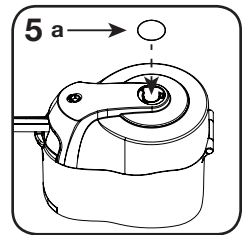

### OPTION - Push Button Lock Option

- a Insert included Push Button (c) and then Snap Button Ring (b) into place on the Pürleve Handle cover. Ensure the larger of the three snaps matches the largest of the three holes on handle cover (Figure 6).

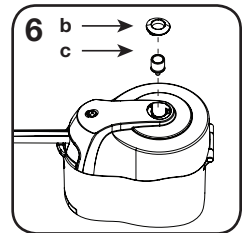

- b With fingers, unscrew the Push Button Connector until almost fully extended (Figure 7).

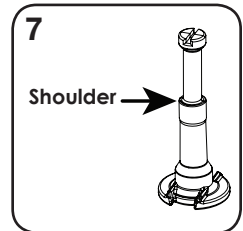

- c Place the push button connector into the back side of the Pürleve Handle through the center (small end first) by matching the RIB of the handle with gap in the connector. Ensure the Push Button Connector drops to the bottom of the hole (Figure 8).

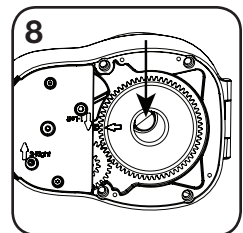

## 3 INSTALL PÜRLEVE HYGIENIC HANDLE

**Note 6:** Ensure the Pürleve Handle is "OFF" until the refill is installed

- a The installed Bored Cylindrical Hardware should be unlocked. The hardware is unlocked if the button is extended (Figure 9). To unlock turn cylinder.

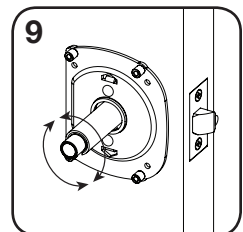

### 3 INSTALL PÜRLEVE HYGIENIC HANDLE (continued)

**b** Place the Pürleve Handle onto the mounting plate, previously installed. Ensure the 4 holes on the backside of the Pürleve Handle match with the 4 threaded inserts on the Mounting Plate. Ensure the Handle is facing AWAY from the edge of the door (Figure 10).

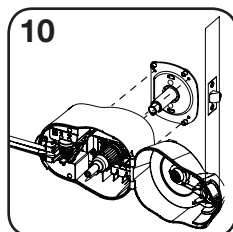

**c** Install the 5/8" (16 mm) pan head machine screws (Qty. 4) into the hygienic handle holes (Figure 11). These screws will fasten the handle to the mounting plate. Do not use a power drill for these screws to ensure you do not OVER tighten the screws and damage the mounting plate threaded inserts.

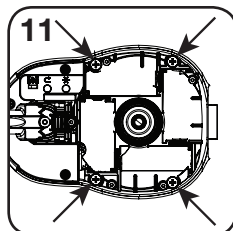

**d** Using a flat head screwdriver, rotate the head of the push button connector clockwise until the shoulder of head is flush with the top of the metal tube inside the handle. Only push lightly on the button connector (Figure 12). See Figure 7 for 'shoulder' visual.

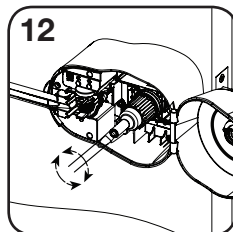

**e** Close Hygienic Handle Cover. Push in the Push Button to test the locking mechanism. If needed, adjust the Push Button Connector in or out until cover button functions smoothly.

**f** Install included C Size batteries (Qty. 4) (Figure 13).

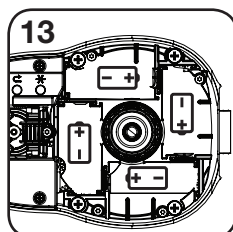

**g** Pürleve Hygienic Door Handle installation complete. To install a Pürleve #1005 Hygienic Refill, follow the instructions included in the refill box. Ensure Pürleve Handle is 'OFF' until the Pürleve #1005 Hygienic Refill is installed.

## Electronic Functions and Instructions

FUNCTIONS	INSTRUCTIONS	RESULT
Turn Unit 'On' with infrared (IR)	Place the switch to 'ON - 1' setting. <b>Note A:</b> Infrared recommended when handle first installed or if significant vandalism in washroom <b>Note B:</b> IR could be problematic in some washroom lighting environments. <b>Note C:</b> 2 Second Sleeve Advance Delay upon releasing hand from handle and IR	When hand placed over or around the handle the sleeve will stop and a Green LED will be lit. When hand removed, the sleeve will start and the Green LED will turn OFF and sleeve cycle will complete.
Turn Unit 'On' without Infrared (IR)	Place the switch to 'ON - 2' setting. Sleeve will continue to run if hand in view. <b>Note D:</b> 3 Second Sleeve Advance Delay upon releasing handle.	To test push down the handle and Release Handle to advance a sleeve.
Turn Unit 'Off'	Place the switch to 'OFF' setting.	Unit is not powered. To test, push down and release the handle to ensure no sleeve activity.
Low Battery Indicator	To check if the dispenser is in a 'LOW' battery life status, simply push down the handle and release. <b>Note E:</b> Only Use this function if a requirement.	1. If the batteries are low in energy, the Red LED will blink 5 times, when the handle is released. 2. If still working, the batteries should be replaced with the next refill.
Low Refill Indicator	To check if the dispenser is in a 'LOW' refill status, push down or pull the handle and release.	1. If the refill is 'LOW' (estimated 250 sleeves remaining) the Yellow LED will blink 5 times with each advancement of the sleeve. 2. The 'LOW' refill indication will continue until a new refill is placed and the new count is activated.
Activate Low Refill Indicator for New Refill	Turn Unit 'On' and push down or pull handle. As the sleeve advances, push the 'ARROW' button for 5 seconds or until the Green LED begins to blink, then release. <b>Note F:</b> To ensure proper counts, only activate this function with a NEW REFILL.	The Green LED will blink 5 times.
De-Activate Low Refill Indicator	Pull or Push Down the Handle. As the sleeve advances, PUSH the Star button for 5 seconds or until the Yellow LED begins to blink.	The Yellow LED will blink 5 times.
Low Battery Indicator - Demonstration	Slide to 'ON - 1' pull or push down and release the handle. As the sleeve is moving, PUSH and HOLD the 'STAR' and 'ARROW' button until the Red LED begins to blink, then release the button.	The Red LED will blink 5 times.
Low Refill Indicator - Demonstration	Slide to 'ON - 2' pull or push down and release the handle. As the sleeve is moving, PUSH and HOLD the 'STAR' and 'ARROW' button until the Yellow LED begins to blink, then release the button.	The Yellow LED will blink 5 times.

# Sold Separately

## Required Accessories

**Note 11:** One of the following two hardware sets is required for a Pūrleve Hygienic Door Handle (#1002) installation: #1003 or #1014

- #1003: Coin Turn Lever Hardware - No key required to release lock on hardware.
  - #1014: Keyed Lever Hardware - Key used to unlock hardware.
  - #1005: Pūrleve Refill Cartridge
- 

## Optional Accessories

- #1012: Pūrleve Industrial Door Closure
- #1016: 2 - 3/8" (60 mm) Latch (Use with Product #1003 - Pūrleve Coin Turn Hardware)
- #1017: 2 - 3/8" (60 mm) Latch (Use with Product #1014 - Pūrleve Keyed Hardware)



A cleaner world is within reach.