

pūrleve™

hygienic door handle

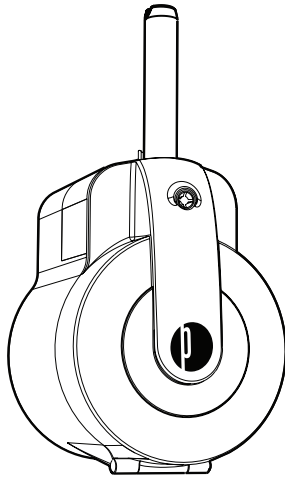

#1001 PŪRLEVE HANDLE INSTALLATION

Hygienic Push or Pull Door Handle System



A cleaner world is within reach.

111 W. Olive Street, Glendale, WI 53212
1.877.PURLEVE | www.purleve.com

Part List

Tools Required

- Cross Tip Screw Driver (Phillips')
- Tape Measure
- Power Drill
- #2 Cross Tip (Phillips') Power Bit (minimum 3 1/2" (88.9 mm))
- 3/32" Drill bit (2.38 mm)
- 1/4" Drill Bit (6.35 mm)
- Level or Carpenters Square
- 1/8" Hex Key Wrench (3 mm)

Tools Recommended

- Center Punch
- 1/2" (12.7 mm) Spade Bit
- Pencil
- Tape

Included Parts

Note 1: See back page for other items required sold separately.

- Pūrleve #1001 Handle
- Pūrleve proprietary key
- C-cell Alkaline Batteries (Qty. 4)
- Pūrleve Handle Installation Template
- Pūrleve Informational Placard (Qty.2)

Included Hardware

Note 2: Use the 'scaled' images as references during installation.

- #8-32 x 1.25" (31.75 mm) Pan Head Machine Screw Insert (Qty. 3)



- #8-32 x 1.25" (31.75 mm) Pan Head Machine Screws (Qty. 3)



- #8 x 1.25" (31.75 mm) Self Tapping Screw (Qty. 4)



Pūrleve Handle #1001 Installation Instructions

Note 3: Installation video located at - www.purleve.com/installation-videos

Door Preparation and Trouble Shooting Guide

- Recommended placement dimensions for the Pūrleve Handle are NOT mandatory. Before drilling any holes, please read through the entire instruction sheet to ensure you avoid holes in the door that are exposed to the user. The goal is to ensure all through holes are covered by the current or new Pūrleve Push Plate.
- Standard Door Thickness is 1 - 3/8" (35 mm) thick. If the door is LESS than 1.375" (35 mm) or GREATER than 1.75" (44.5 mm) the system will not function properly. Call Pūrleve for support.
- The following instructions cover standard Solid Wood Doors.
- For Fiberglass or Hollow Core Wood Doors, please see alternative directions in Handle Box or call Pūrleve.
- Metal Door installation is similar to these instructions. Call Pūrleve with any questions.
- If no installed door return mechanism on door, please call Pūrleve to purchase an Industrial Door Closure #1012.
- If there is a handle or handle door plate already in place please remove. The Push Plate on the opposite side of the Handle can remain or be replaced with the Pūrleve Push Plate #1007.
- If installing a Pūrleve Door Plate behind the handle go to Step 1. If not, go to Step 2. Pūrleve suggests installing Pūrleve Door Plate first and using this as the template for the handle installation.

1 INSTALL PÜRLEVE DOOR PLATE

Note 4: It is recommended, but not mandatory, that centerline of two middle holes should be about 38" (96.52 cm) from the floor (Figure 1).

Note 5: Before mounting the Pürleve Door Plate, ensure that the holes #1,2, and 3 will be covered by the currently installed Push Plate on the other side of the door OR will be covered by the Pürleve Push Plate. Otherwise, the holes will be viewable from the other side of the door.

- a Place the Pürleve Door Plate against the door (chamfers on holes facing out) approximately 3/4" (1.9 cm) from the door edge and 38" (96.52 cm) from bottom of door to centerline of two middle holes (Figure 1).

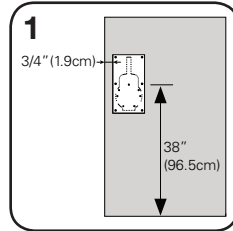

- b Use the Pürleve Door Plate as a template for the screw holes. Mark the center of all six Pürleve door plate holes and the other 7 Pürleve dispenser installation holes using a center punch, nail or screw tip (Figure 2).

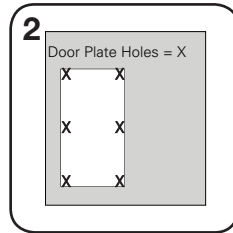

- c Use a 3/32" (2.38 mm) drill bit, drill the 6 door plate pilot holes about 3/4" (1.9 cm) into the door.

- d Use the #1 or #2 Phillips Head Bit, install all 6 Pürleve door plate screws (Figure 3).

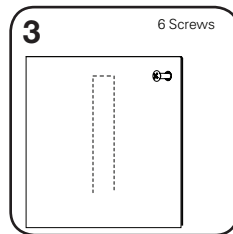

2 PREPARE DOOR FOR INSTALLATION

Note 6: If the Pürleve door plate was installed in step#1, go to step 2-d. If not, please go to step 2-a.

Note 7: Holes #4, 5, 6 and 7 are only required if more strength is needed. Drill pilot holes with the 3/32" (2.38 mm) drill bit to a depth of approximately 3/4" (1.9 cm).

WARNING: If door is not standard 1 3/8" (35 mm) thick, ensure the drilled holes does not go through the door. Recommend drilling no more than half the thickness of the door. Be careful making holes and using inserts with hollow doors.

- a Place centerline of template on door, 38" (96.5 cm) from floor (ADA recommended). Use a carpenter's square or level to make sure that centerline of holes is square to the door. Tape template to door and follow template.

- b **See Note 7.** Use Pürleve handle template included OR the holes in the Pürleve Door Plate installed in Step 1. Mark the center points for the seven Pürleve mounting holes (Figure 4).

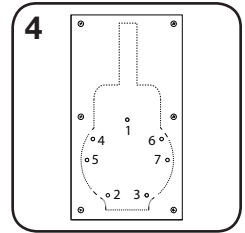

- c Drill Holes #1, 2, 3 with the 1/4" (6.35 mm) drill bit through the door.

- d One by one place (tap) the inserts into the door until fully installed. (Figure 5)

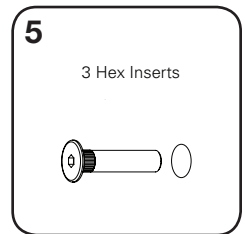

3 INSTALL PÜRLEVE HYGIENIC HANDLE

Note 8: After installing screws #1, 2, and 3, ensure the inserts on the other side of door remain flush.

- a Insert the Pürleve key into cover lock, turn either direction and open cover. (Figure 6).

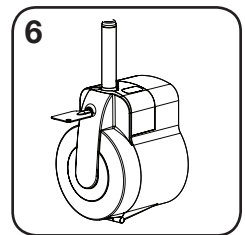

- b Place the Pürleve handle against the door as shown. Line up the seven mounting holes (Figure 7).

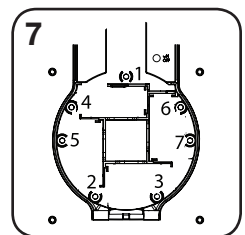

c Using #1 and #2 Phillips bit, insert three pan head machine screws (#8-32 x 1.25" (31.75 mm)) into holes (#1,2,3). These holes have the 'inserts' installed on the opposite side of the door, use a 1/8" (3.175 mm) hex key wrench to keep insert stationary when placing screws. Tighten the screws until the unit is snug to the door. Do not over tighten as minor adjustments may be needed to line up all the remaining mounting holes.

d Install remaining screws #4, 5, 6, and 7 (only if necessary).

e Install included C Size Alkaline batteries (Qty. 4) (Figure 8)

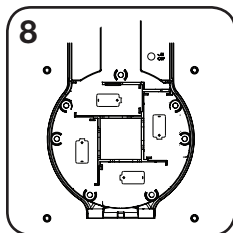

f Pürleve Hygienic Door Handle installation complete. To install a Pürleve #1004 Hygienic Refill, follow the instructions included in the refill box. Ensure Pürleve Handle is 'OFF' until #1004 Hygienic Refill is installed.

4 INSTALL PÜRLEVE DOOR PUSH PLATE

Note 9: If a generic Door Push plate is already installed on the door and meets the customers needs, the Pürleve Door Plate #1006 not required.

Note 10: Centerline of two middle holes should be about 38" (96.5 cm) from the floor or where needed to cover the screw through holes from Pürleve handle.

a Push plate should cover any 'Through' holes

b Place Pürleve door push plate approximately 3/4" (19 mm) from door edge (Figure 10.)

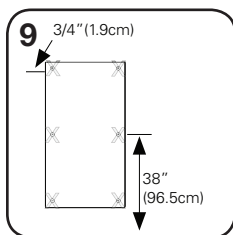

Electronic Functions and Instructions

FUNCTIONS	INSTRUCTIONS	RESULT
Turn Unit 'On' with infrared (IR)	Place the switch to 'ON - 1' setting. Note A: Infrared recommended when handle first installed or if significant vandalism in washroom Note B: IR could be problematic in some washroom lighting environments. Note C: 2 Second Sleeve Advance Delay upon releasing hand from handle and IR	When hand placed over or around the handle the sleeve will stop and a Green LED will be lit. When hand removed, the sleeve will start and the Green LED will turn OFF and sleeve cycle will complete.
Turn Unit 'On' without Infrared (IR)	Place the switch to 'ON - 2' setting. Sleeve will continue to run if hand in view. Note D: 3 Second Sleeve Advance Delay upon releasing handle.	To test push down the handle and Release Handle to advance a sleeve.
Turn Unit 'Off'	Place the switch to 'OFF' setting.	Unit is not powered. To test, push down and release the handle to ensure no sleeve activity.
Low Battery Indicator	To check if the dispenser is in a 'LOW' battery life status, simply push down the handle and release. Note E: Only Use this function if a requirement.	1. If the batteries are low in energy, the Red LED will blink 5 times, when the handle is released. 2. If still working, the batteries should be replaced with the next refill.
Low Refill Indicator	To check if the dispenser is in a 'LOW' refill status, push down or pull the handle and release.	1. If the refill is 'LOW' (estimated 250 sleeves remaining) the Yellow LED will blink 5 times with each advancement of the sleeve. 2. The 'LOW' refill indication will continue until a new refill is placed and the new count is activated.
Activate Low Refill Indicator for New Refill	Turn Unit 'On' and push down or pull handle. As the sleeve advances, push the 'ARROW' button for 5 seconds or until the Green LED begins to blink, then release. Note F: To ensure proper counts, only activate this function with a NEW REFILL.	The Green LED will blink 5 times.
De-Activate Low Refill Indicator	Pull or Push Down the Handle. As the sleeve advances, PUSH the Star button for 5 seconds or until the Yellow LED begins to blink.	The Yellow LED will blink 5 times.
Low Battery Indicator - Demonstration	Slide to 'ON - 1' pull or push down and release the handle. As the sleeve is moving, PUSH and HOLD the 'STAR' and 'ARROW' button until the Red LED begins to blink, then release the button.	The Red LED will blink 5 times.
Low Refill Indicator - Demonstration	Slide to 'ON - 2' pull or push down and release the handle. As the sleeve is moving, PUSH and HOLD the 'STAR' and 'ARROW' button until the Yellow LED begins to blink, then release the button.	The Yellow LED will blink 5 times.

Sold Separately

Required Accessories

- #1004: Pūrleve Refill Cartridge
-

Recommended Accessories

- #1007: Pūrleve Handle Door Plate
 - #1012: Pūrleve Industrial Door Closure
-

Optional Accessories

- #1006: Pūrleve Push Plate



A cleaner world is within reach.